

BANJO BOLTS

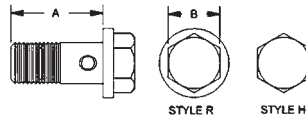

Banjo Bolts

A banjo bolt for every application.

FEATURES:

- Reduced head size for appearance & less interference
- Zinc plated for corrosion resistance
- Imperial & Metric Threads

Assortment kit available.
To order see Part No. **BQ7007**.

PART NO.	THREAD	HEAD STYLE	A	B
BQ8078	M12 x 1.25	R	25mm [1"]	14mm
BQ8083	M10 x 1	H	34.5mm [1-3/8"]*	14mm
BQ8084	M10 x 1.25	H	34.5mm [1-3/8"]*	14mm
BQ8085	3/8" x 24NF	H	34.5mm [1-3/8"]*	9/16"
BQ8086	M10 x 1.5	R	24mm [15/16"]	12mm
BQ8087	M11 x 1.25	R	24mm [15/16"]	13mm
BQ8088	M10 x 1.5	R	27mm [1-1/16"]	12mm
BQ8089	7/16" x 20NF	R	24mm [15/16"]	7/16"
BQ8090	7/16 x 24NS	R	27mm [1-1/16"]	1/2"
BQ8092	M12 x 1.5	R	25mm [1"]	14mm
BQ8093	3/8" x 24NF	R	25mm [1"]	12mm
BQ8094	M10 x 1	R	26mm [1"]	12mm
BQ8095	M10 x 1	R	22mm [7/8"]	12mm
BQ8096	7/16" x 20NF	R	27mm [1-1/16"]	11mm
BQ8097	1/2" x 20NF	R	30mm [1-3/16"]	9/16"
BQ8098	M12 x 1	R	21mm [13/16"]	13mm
BQ8099	M10 x 1.25	R	22mm [7/8"]	12mm

* Double Banjo Bolt.

BLEED SCREWS

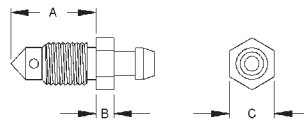

Bleed Screws

These popular bleed screws makes replacement easy.

FEATURES:

- Heavy duty hex allows for good gripping
- Zinc plated for corrosion resistance
- Imperial & Metric Threads

Assortment kit available.
To order see Part No. **BQ7014**.

PART NO.	THREAD	A	B	C
BQ4433	3/8" x 24NF	20mm	5mm	10mm
BQ4434	M10 x 1	23mm	6mm	10mm
BQ4435	M10 x 1	19mm	6mm	10mm
BQ4438	5/16 x 24NF	17.5	5mm	5/16
BQ4439	1/4 x 28NF	15mm	5mm	1/4
BQ4440	M10 x 1.5	18mm	5mm	10mm
BQ4441	M7 x 1	22mm	5mm	1/4
BQ4442	M8 x 1.25	22mm	5mm	8mm
BQ4443	M8 x 1	18mm	5mm	8mm
BQ4444	7/16 x 24NS	24mm	5mm	7/16
BQ4445	7/16 x 20NF	21mm	5mm	7/16
BQ4446	M10 x 1.25	21mm	5mm	10mm

MALE TEST ADAPTERS

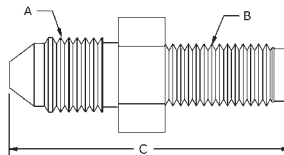

Male Test Adapters

These handy test Adapters can be used for a variety of applications including tapping into your hydraulic system for pressure readings. Will fit most bleed screw openings.

FEATURES:

- Imperial & Metric Threads
- Take off point are universal JIC ends
- Zinc plated for corrosion resistance

Assortment kit available.
To order see Part No. **BQ7010**.

PART NO.	A	B	C
BQ128	3/8" x 24NF (No. 3 JIC)	M10 x 1.25	36mm
BQ129	3/8" x 24NF (No. 3 JIC)	M10 x 1.00	36mm
BQ130	3/8" x 24NF (No. 3 JIC)	M10 x 1.5	60mm
BQ131	7/16" x 20NF (No. 4 JIC)	3/8" x 24NF	37mm
BQ132	3/8" x 24NF (No. 3 JIC)	1/4" x 28NF	36mm
BQ133	3/8" x 24NF (No. 3 JIC)	5/16" x 24NF	36mm
BQ134	7/16" x 20NF (No. 4 JIC)	7/16" x 24NS	37mm
BQ135	3/8" x 24NF (No. 3 JIC)	3/8" x 24NF	36mm
BQ144	7/16" x 20NF (No. 4 JIC)	M12 x 1.00	37mm
BQ145	7/16" x 20NF (No. 4 JIC)	M10 x 1.00	30mm
BQ157	3/8" x 24NF (No. 3 JIC)	1/8" x 28BSPP	30mm